

Qube Pivot Mount

- Complete mounting system with hardware included
- Single or dual wheel uses same mount
- Easy machine attachment
- Accepts Series 21/22 Qube Encoders

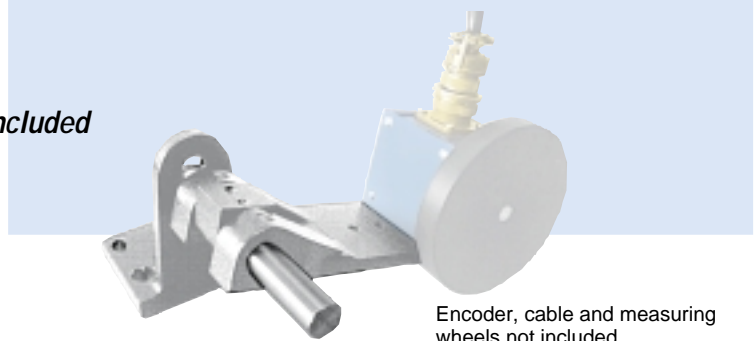

Encoder, cable and measuring wheels not included

APPLICATION/INDUSTRY

Provides adjustable mounting and self-tracking for compatible encoders.

DESCRIPTION

Provides mounting and self-tracking for Series 21, 22, QUBE encoders. Double ended shaft encoders may be equipped with two measuring wheels.

SPECIFICATIONS

DIMENSIONS

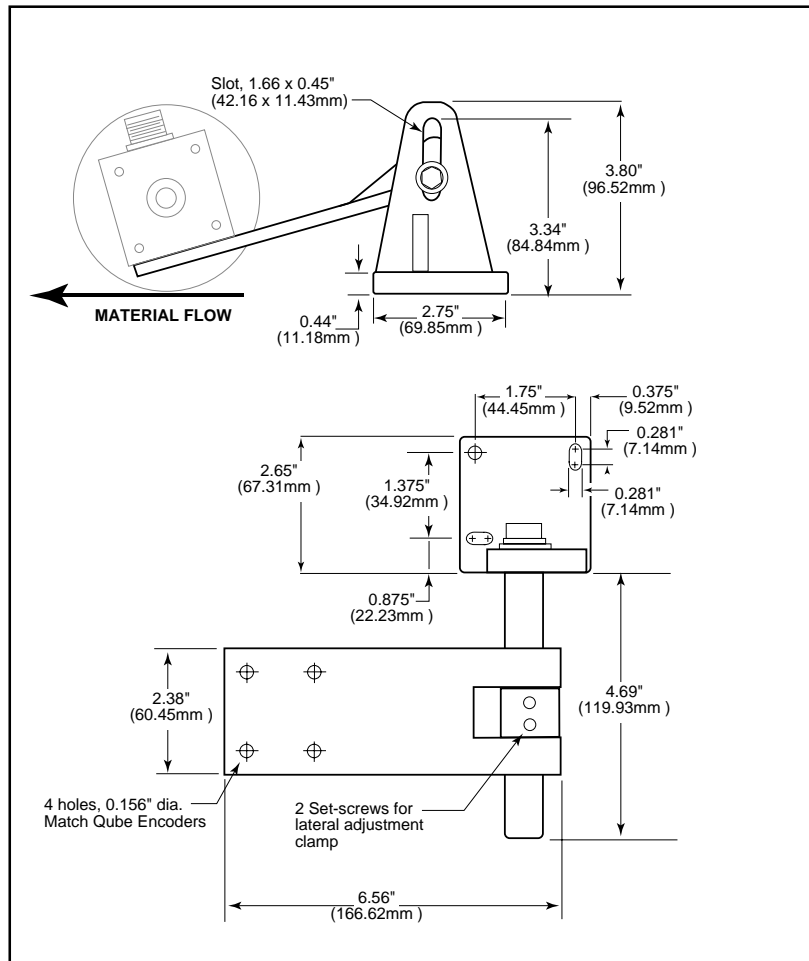

ACCESSORIES

Stocked, Distributed, and Supported by

SENSORS
INCORPORATED

507 Kelsey Street • Delano, MN 55328
Phone 763-972-1040 Fax 763-972-1041
Toll Free 888-920-0939
Sensorsincorporated.com

Ordering Information

Model No.	Description
111328-0001	Qube Pivot Mounting Base

INSTALLATION

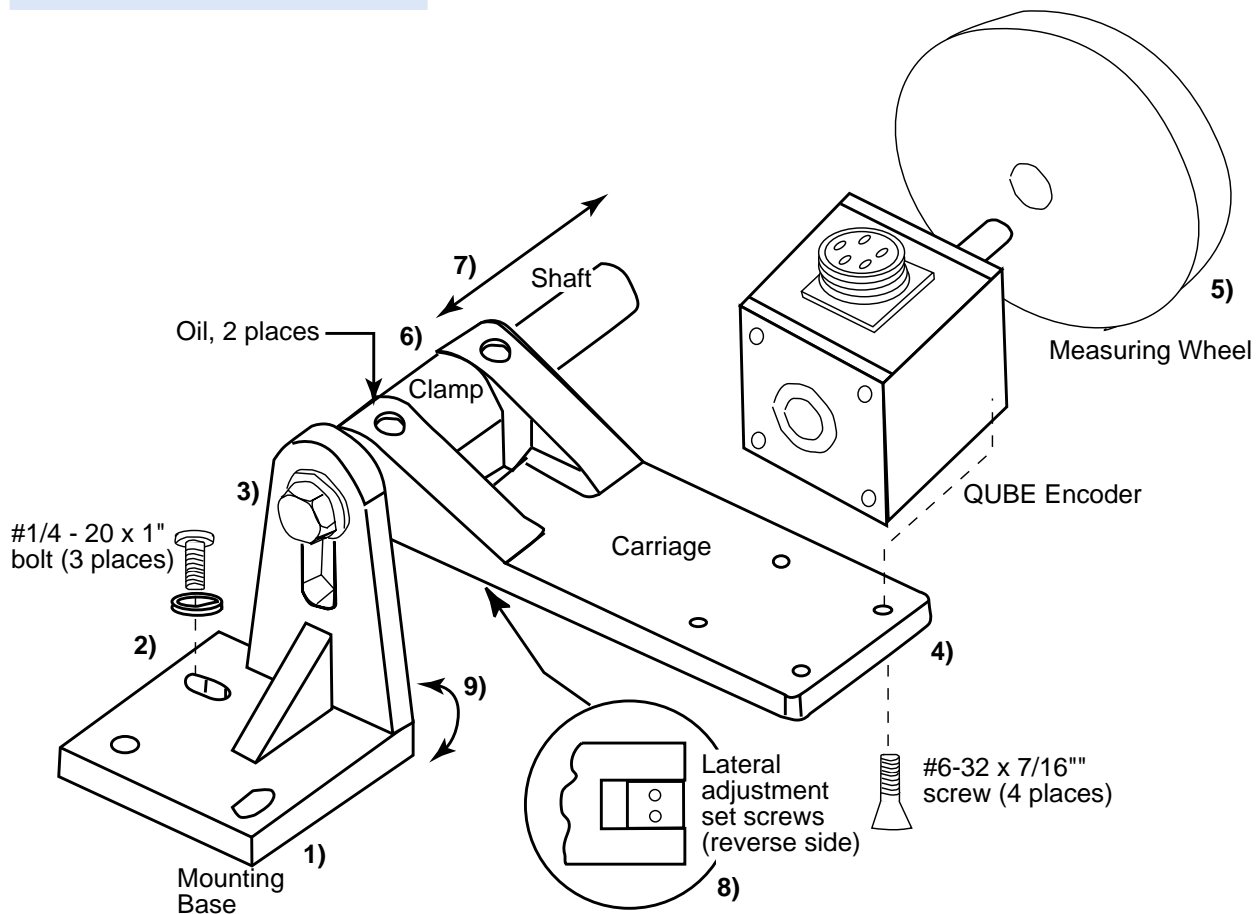

ACCESSORIES

Procedure

Series 21/22 QUBE Encoders, single or dual measuring wheel

- 1) Prepare mounting surface by drilling and optionally tapping (3) holes matching clearance holes in bracket's mounting base.
- 2) Attach base to mounting surface using (3) #1/4-20 x 1" bolts, flat washers and lock washers (provided). If holes were not tapped, longer bolts and nuts (not provided) may be required. Leave bolts "finger" tight.
- 3) Assemble shaft to mounting base using provided #3/8-16 x 3/4" bolt, flat washer and lock washer. Tighten securely.
- 4) Align (4) holes in base of encoder with counter-bored holes in bracket carriage. Secure with (4) #6-32 x 7/16" flat-head machine screws (provided).
- 5) Attach measuring wheel to encoder's shaft. Tighten securely. Avoid wheel rubbing against encoder body. Dual shaft encoders may be fitted with two measuring wheels.
- 6) Place clamp in cavity provided in carriage. Slide carriage/clamp assembly on to shaft.
- 7) Adjust lateral extension of carriage to position measuring wheel at desired location on material.
- 8) Tighten clamp set screws to secure.
- 9) Swivel mounting base to adjust position of the measuring wheel to be parallel with measured material's direction of motion. Tighten bolts to secure base to mounting surface.